



*User's Manual*

# **DOG RUNNER**

## ***REVOLUTION PRO***



THE SPECIFICATIONS OF THIS PRODUCT MAY VARY FROM THIS PHOTO  
AND ARE SUBJECT TO CHANGE WITHOUT NOTICE.

FOR MAXIMUM EFFECTIVENESS AND SAFETY, PLEASE READ THIS  
USER'S MANUAL BEFORE USING YOUR TREADMILL.

1. OVERVIEW DRAWING.....	1
2. IMPORTANT SAFETY INSTRUCTIONS.....	2
3. GROUNDING INSTRUCTIONS.....	3
4. PRE-ASSEMBLY CHECK LIST.....	4
5. ASSEMBLY STEPS.....	5
6. MAINTENANCE.....	9
7. COMPUTER OPERATION INSTRUCTIONS.....	10
8. EXPLODED VIEW.....	13
9. PARTS LIST.....	14

## OVERVIEW DRAWING

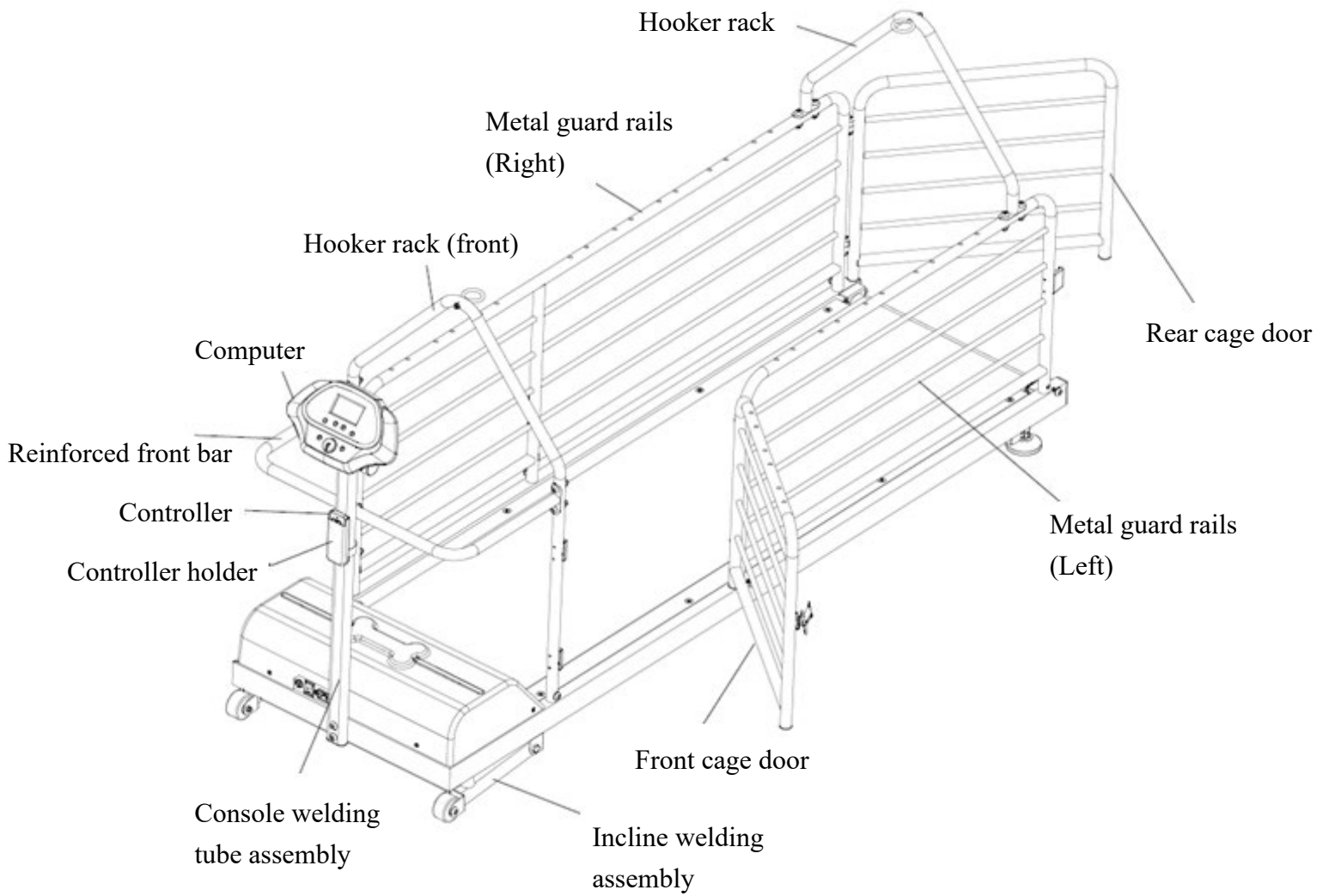

***Before using this treadmill, basic precautions should always be followed, including the following:***

- To ensure user safety and protect the unit, read all the instructions before assembling and using the treadmill.



### **WARNING**

- Do not use this product outdoors, near swimming pools or in damp, wet locations.
- Assemble and operate the treadmill on a solid, level surface. Provide the following clearances: 1 m (3 feet) at each side, 2 m (6 feet) at the back. Be sure the treadmill is clear of any obstructions, including walls, furniture and other hard surface. Place a protective sheet below the treadmill to protect the floor or carpet from possible damage. Check the treadmill before each use and verify that all fasteners are secure.
- To reduce the risk of electrical shock, always unplug this treadmill from the electrical outlet immediately after using it and before cleaning, attempting any maintenance tasks or before removing the treadmill.
- Do not adjust the running belt when dog is standing on the treadmill.
- Keep the power cord away from heated surface and sharp edges.
- Never operate this treadmill if it has a damaged power cord or plug, if it is not working properly, if it has been damaged or dropped or if it has been submerged in water. In these cases, this treadmill should be examined by a qualified service technician.
- Do not modify or attempt any service on the treadmill yourself, seek trained repair personnel when servicing. Contact the nearest authorized dealer or other competent repair service.
- Connect this treadmill to a properly grounded outlet only. Improper connection of the power cord can result in a risk of electric shock. Check with a qualified electrician or serviceman if you are in doubt as to whether the treadmill is properly grounded. Do not modify the plug provided with the treadmill. If it will not fit in the outlet, have a proper outlet installed by a qualified electrician.
- Do not use the treadmill in areas where aerosol spray products are being used or where oxygen is being administered. Such substances create the danger of combustion and explosion.
- Do not use the treadmill if user exceed 130kgs. (285lbs). This is the rated maximum user weight.
- Keep the running belt clean and dry all times.
- Be sure the power cord has plenty of slack and does not get pinched underneath the treadmill when it elevates and declines.
- Do not leave the treadmill unattended when plugged in and running. After turning off the treadmill, don't leave it until it comes to a complete stop and is level. To disconnect, turn all controls to the STOP or OFF position, and then remove the plug from the outlet.

**Note: Read all instructions and save for future use.**

The treadmill needs special power supply:

Power supply voltage (V)	Frequency (HZ)	Rated current (A)
100	50/60	18
120	50/60	18
200	50/60	9
220	50/60	9
230	50/60	9
240+	50/60	9

## DANGER!

Wirings follow the local country electrical regulations, high voltage, low voltage wires, and grounding wires must be separately transported and can't connect with or twist other wires. The product must be grounded to prevent electric shock, but improperly connect grounding device of treadmill can also lead to electric shock. If you are not sure whether the grounding device has been properly connected, you can consult the electrician or service personnel. If the plug is not suitable for the power supply socket, please do not replace the plug provided with the product, please ask professional electrician for installation

**Figure**  
**Grounding methods**

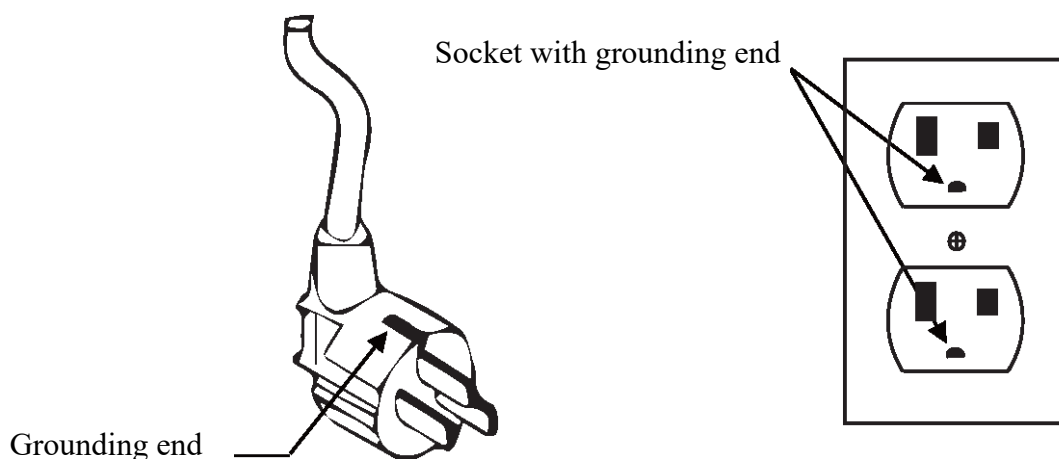

## PRE-ASSEMBLY CHECK LIST

No.	Description	Q'ty
A	Frame	1
B	Hooker rack (Front)	1
C	Reinforced front bar	1
D	Console welding tube assembly	1
E	Metal guard rails (right) assembly	1
F	Metal guard rails (left) + front cage door	1
G	Rear cage door	1
H	Hooker rack	1
I	Computer assembly	1

No.	Description	Q'ty
a	Hex screw	6
b	Hex screw	12
c	Hex screw	3
d	Curved washer	13
e	Nylock	13
f	Hex Wrench	1
g	Wrench tool	1
h	Screwdriver	1
i	Silicon oil	1
j	Safety key	1
k	Controller	1
l	Power cord	1
m	Truss phillips self- tapping screw	2
n	Controller holder	1

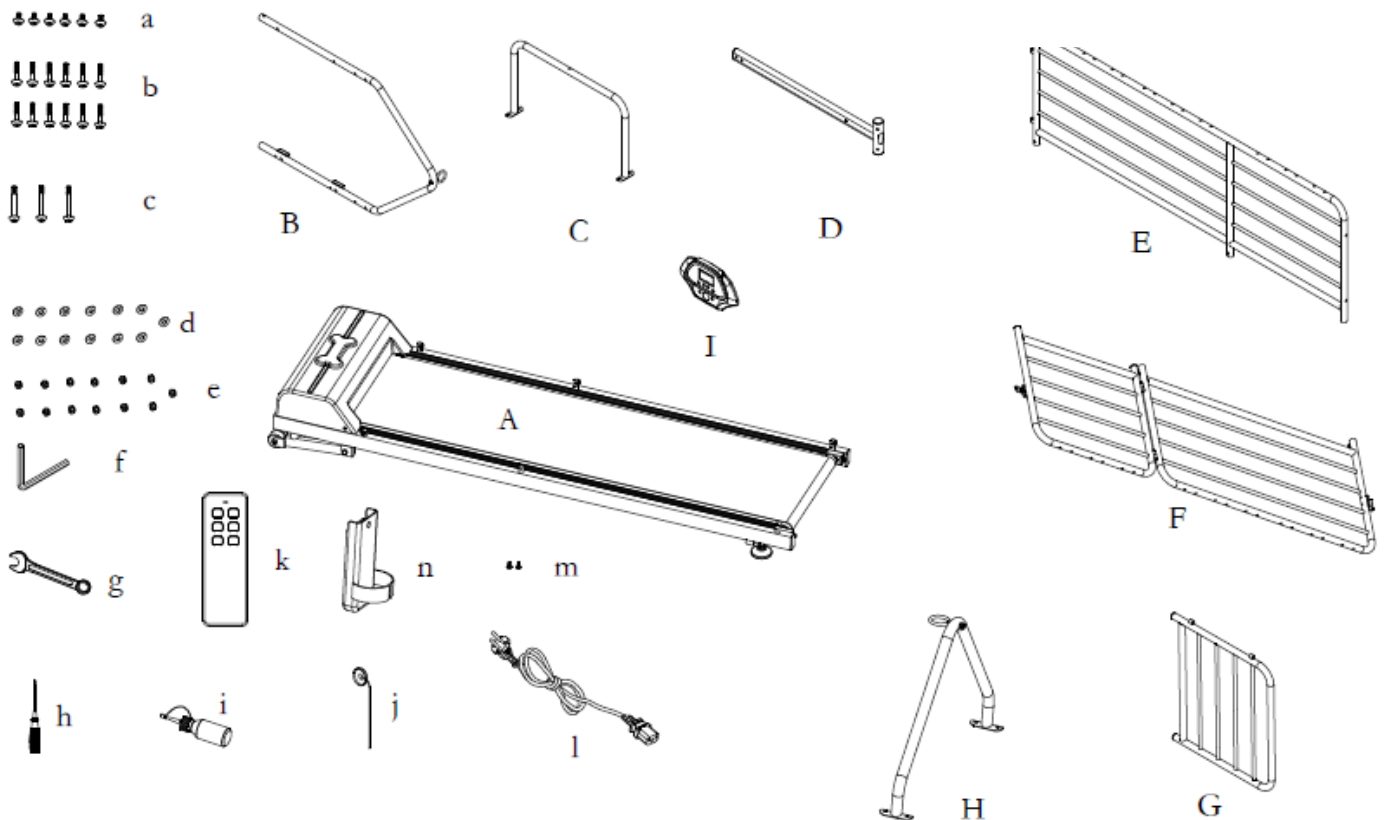

## ASSEMBLY STEPS

### Step 1.

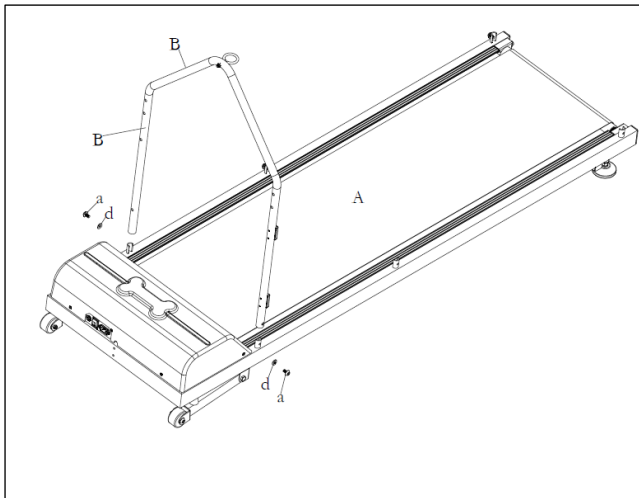

Assemble front hooker rack set (B) onto Frame (A) but not tighten , screw hooker rack (front set) (B) tightly by hex screw (a) and curved washer (d) as left figure showing.

### Step 2.

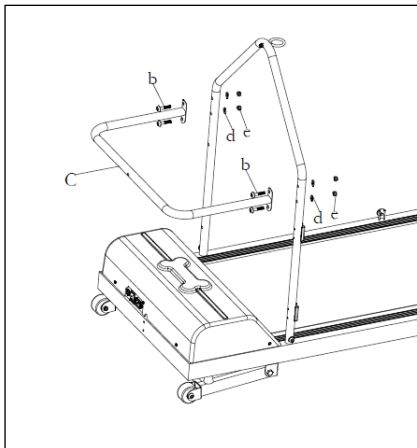

Assemble Reinforced front bar (C ) but not tighten, screw tightly by hex screw, curved washer and Nylock (b,d,e) as left figure showing.

### Step 3.

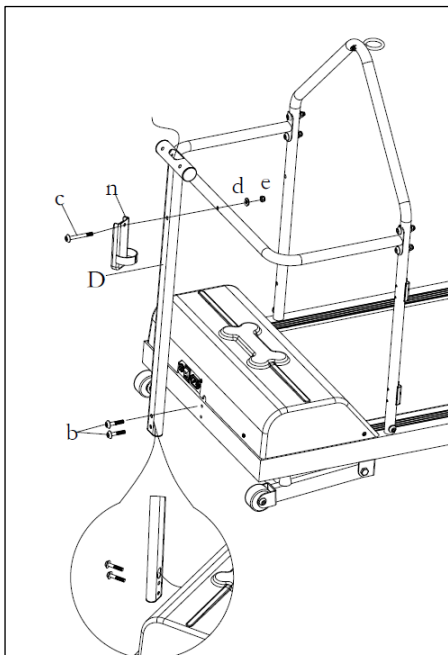

1. First step, insert control cables from bottom of console tube (D) and pull out from top end, using the hex screws (b) to fix console tube (D) on frame firmly.

2. Attach uprights (n, c) on base frame, fix upright with hex screws (a), washers (b) and truss hex screws(c).

3. Assemble together, fasten the velcro strap on the remote control

Note: Not tighten the screw at this moment

#### Step 4.

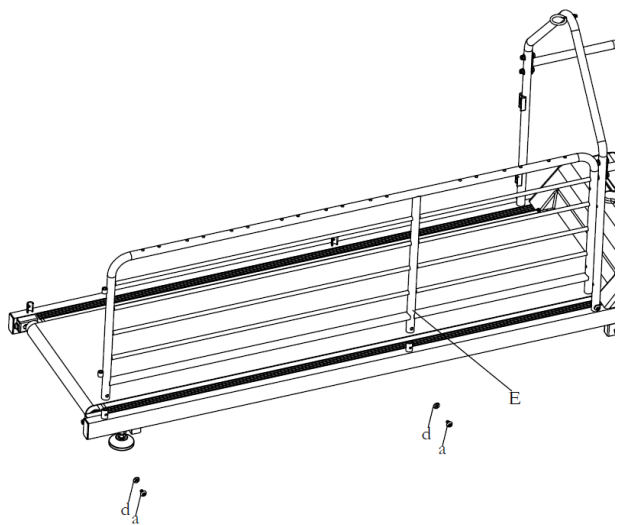

1. Assemble right side guard rails assembly ( E ) onto frame, and tighten with the hex screw and curved washer (a,d) as left figure showing.
2. Assemble front hooker rack (B) with right side rails ( E ) by hex screw, curved washer and Nylock (c,d,e) as left figure showing.

Note: Not tighten the screws at this moment

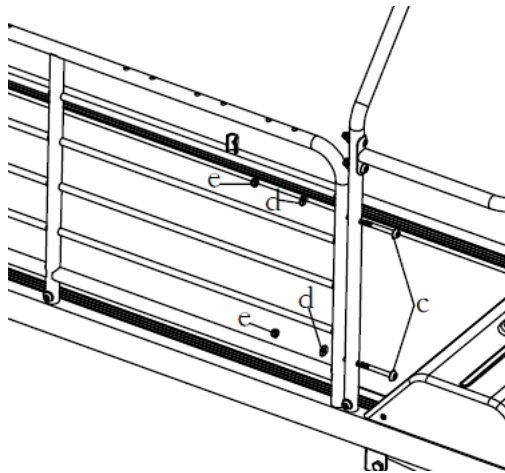

#### Step 5.

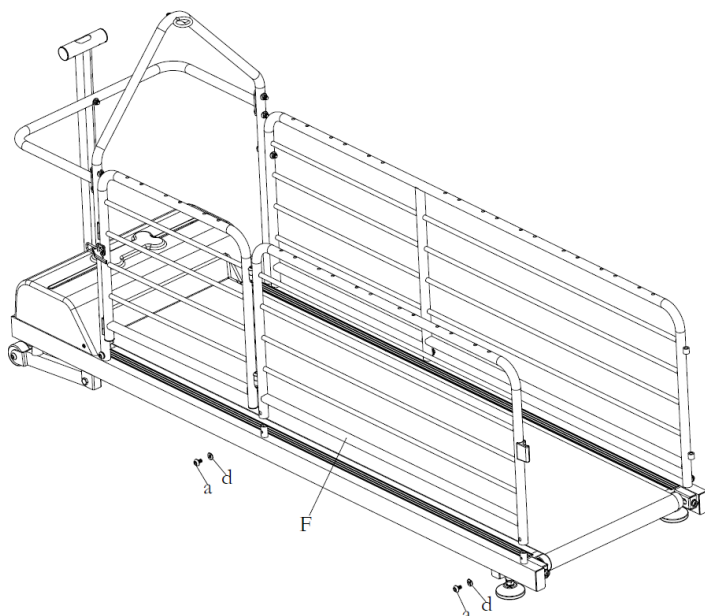

Assemble Metal guard rails (left) + front cage door (F) onto frame by hex screw and curved washer (a,d) as left figure showing.

Note: Not tighten the screws at this moment



### Step 6.

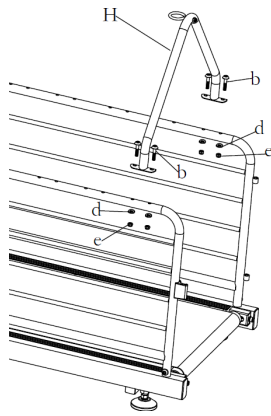

Assemble front hooker rack set (H) onto metal guard rails with the hex screw, curved washer and Nylock (b,d,e) as left figure showing.

Note: Not tighten the screws at this moment

### Step 7.

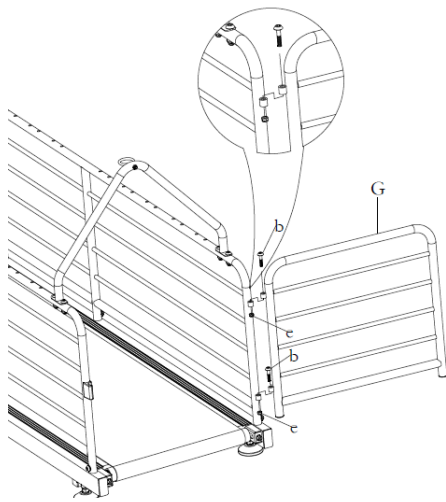

Assemble rear cage door set (G) with right guard rails ( E ) with the hex screw and Nylock (b,e) as left figure showing.

Note: Not tighten the screws at this moment

### Step 8.

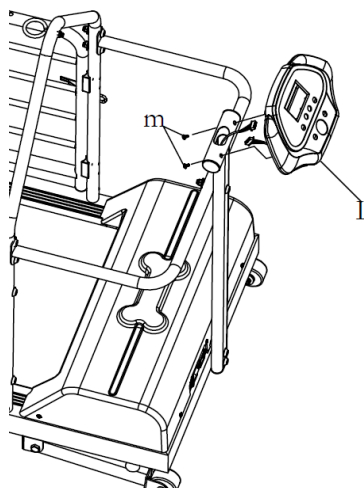

Well connect control cables with Computer assembly (I). Then put the Computer (I) and tighten Console welding assembly with the Truss phillips self tapping screw (m) as left figure showing.

### Step 9.

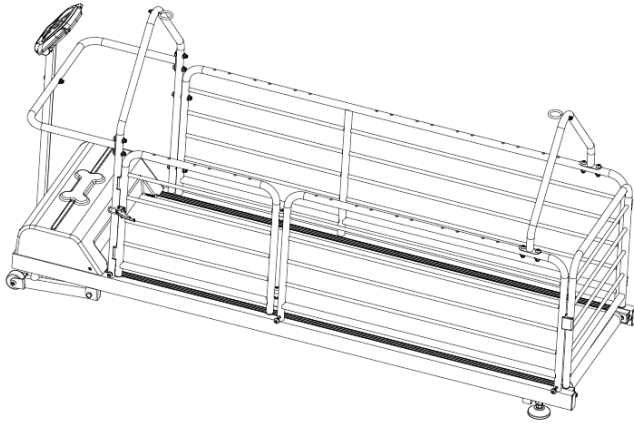

Tighten with all the screws from Step1 to 7 as left figure showing.

### Step 10.

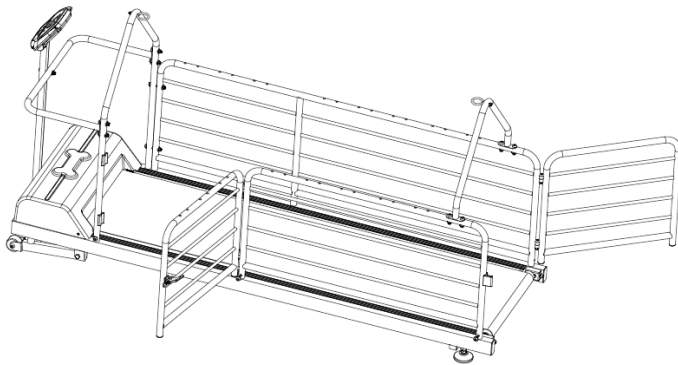

Now finish assembly, the front rails door and rear rails door can be can opened as options.

When open the doors , The door must be pulled out of the plastic buckle with a little bit of force; to make the door clip onto plastic with force when the door is closed.

After front door is closed tightly, close the buckle again.

### Running Belt Adjustment

If the running belt is not in the center, stop the treadmill then adjust the Hex Screw in the Rear End Cap by the Hex Wrench. For example, if the running belt is moving towards the left side, turn the left Hex Screw about  $\frac{1}{4}$  circle (clockwise). If the running belt is moving towards the right side, turn the right Hex Screw about  $\frac{1}{4}$  circle (clockwise). Turn on the treadmill after it has been adjusted. If you find that the belt does not move to the proper position, please repeat above steps. Do not use the treadmill until the running belt returns to the center position.

(Ps.1. This action is very important, if the belt is not in the center, be sure to follow above steps.)

(Ps.2. The position of the running belt might not stay precisely in the center with slightly towards the left or right side, and the situation varies with how end-users use and the weight of end-users. No need to adjust the belt if it does not rub against the parts aside.)

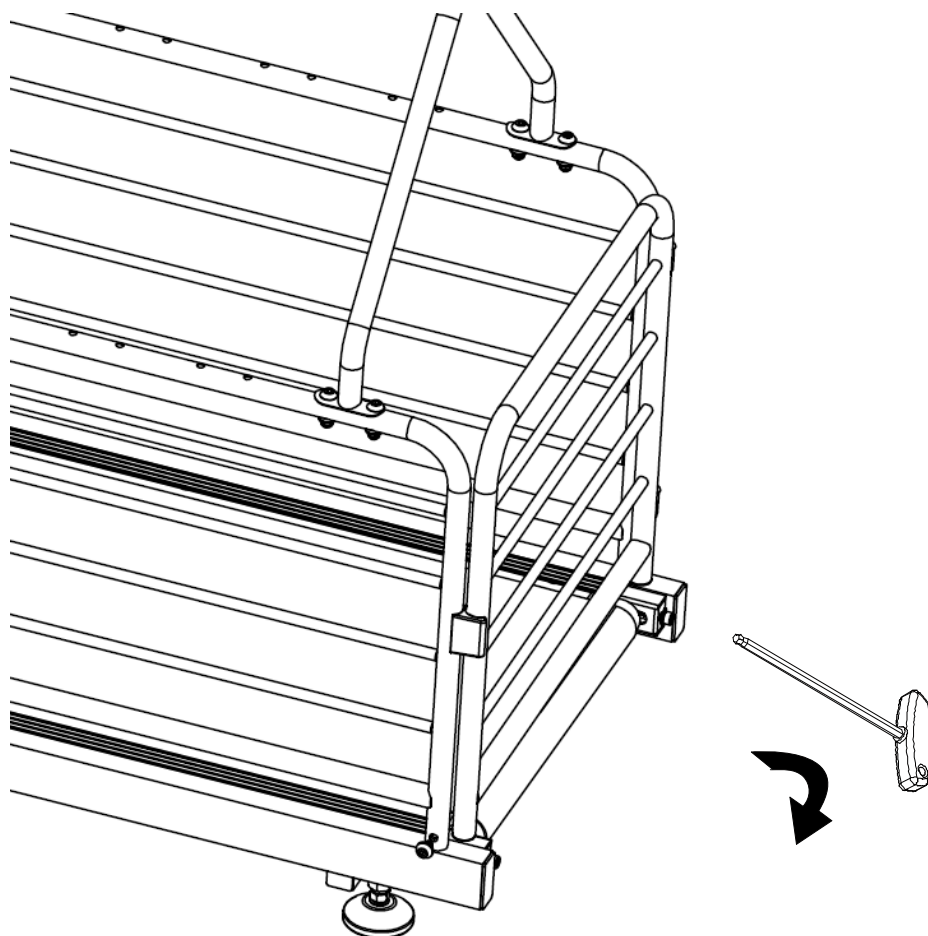



## **1. Operation Instruction – Power on display -**

After turn on machine without putting on safety key, all data display as “- - -” beeper makes “beep” sound.

After put on safety-key , SPEED window display shows “1.0”, other window display with flash for 1 second, then all data display resume to ZERO.

Turn on machine display: recognize program, under countdown mode, press “START” button, widow display shows 3 – 2 – 1 with beep to count down then machine starts.

## **2. BUTTON FUNCTIONS:**

### **STOP/START:**

Start - At the time of treadmill stand-by mode, Program mold and Time countdown mode, press the STOP/START key, console displays show speed. After countdown for 3 seconds, treadmill starts.

Stop - During treadmill running, press the STOP/START key, incline stops and the treadmill stops and returns to stand-by mode, all workout data return to zero after machine stops completely.

PROGRAM button: Under STAND-BY condition, this button can alternatively choose manual mode or Pre-set program. Pre-set programs has P01 – P04.

Time countdown mode: TIME window display”30 :00” and flash, Use “SPEED” button +/- to adjust time setting, range : 5:00-99:00, each adjustment : 1:00.

MODE - This key is able to adjust speed from 0.8-15km/h.

Each program running to finish, machine will stop gradually, TIME window display END, Incline return to ZERO, beep sound with flash for 10 seconds, then all data return to ZERO and resume to stand-by condition.

Program Table:

4 Pre-set programs P01-P04 as following listed. Each pre-set program has 10 different segments with varied speed and incline workout program for each segment as below illustrated.

		1	2	3	4	5	6	7	8	9	10
P01	Speed	4	6	8	10	12	12	10	8	6	4
	Incline	0	1	3	5	1	1	3	3	1	0
P02	Speed	6	8	10	12	14	14	12	10	8	6
	Incline	1	3	3	1	2	2	1	3	3	1
P03	Speed	8	10	12	14	15	15	14	12	10	8
	Incline	0	1	2	2	0	0	2	2	1	0
P04	Speed	User setting program – can customized program for speed and incline can be saved.									
	Incline										

**SPEED** +/- button: After starting machine, can use for adjusting speed, each adjustment is 0.1KM, if press the button after more than 2 seconds, will continuously increase speed or decrease speed.

**INCLINE** +/- button: After starting machine, can use for adjusting incline, each adjustment is 1%, if press the button after more than 2 seconds, will continuously increase incline or decrease incline.

### 3. USER SETTING PROGRAMS

Press program button to enter P04 (user program), press program button for 2 seconds with beep sound and enter mode setting condition. Windows for Incline and Speed display with flash, TIME window display current setting segment, press INCLINE or SPEED button to adjust current setting value for incline or speed. After finishing setting value, press PROGRAM button for 2 seconds to save the input setting value ( Max setting speed: 15 KM/H).

## 4. Console Instructions:

4. 1 Computer display descriptions:

4. 2 Display function:

Speed : Display current exercise speed value:

Time: Display the running time in manual mode or the countdown of running time in countdown mode.

Distance : Shows the accumulated distance under manual or program mode, or the countdown of distance in running mode.

Calorie : Shows calories accumulated during exercise in manual and program modes, or countdown of calories in running mode.

Incline : /display current exercise incline value

Window Topic	Display Range
TIME	<b>In exercising mode: 0:00-99:59 (Minute:Second)</b> <b>In setting mode: 5:00 99:00 (Minute:Second), adjustment step 1 min/per time</b>
DISTANCE	<b>In exercising mode: 0:00-99:99 (KM)</b> <b>In setting mode: 1-99 (KM), adjustment step 1 km/per time</b>
CALORIES	<b>In exercising mode: 0-999 (CAL)</b> <b>In setting mode:20-990, adjustment step 10 cal /per time</b>
SPEED	<b>Min 0.8-Max 18.0 (KPH), adjustment step 0.1/ per time</b> <b>Will show version no. right after power on.</b>
INCLINE	<b>0-15 Level, adjustment step 1 level /per time.</b>

## 5. Remote Control Function

Usage: Take the remote control close to the matching treadmill, simultaneously press buttons of **P** and **⏻** until the LED light flash 3 times then matching completely, if matching failed, the LED light will be flashing for long.

Operation Instruction: The 6 buttons as illustrated below, these button are with same functions as matching buttons on treadmill.

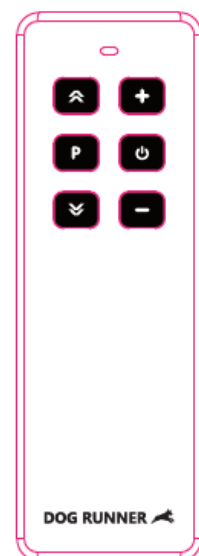

# EXPLODED VIEW

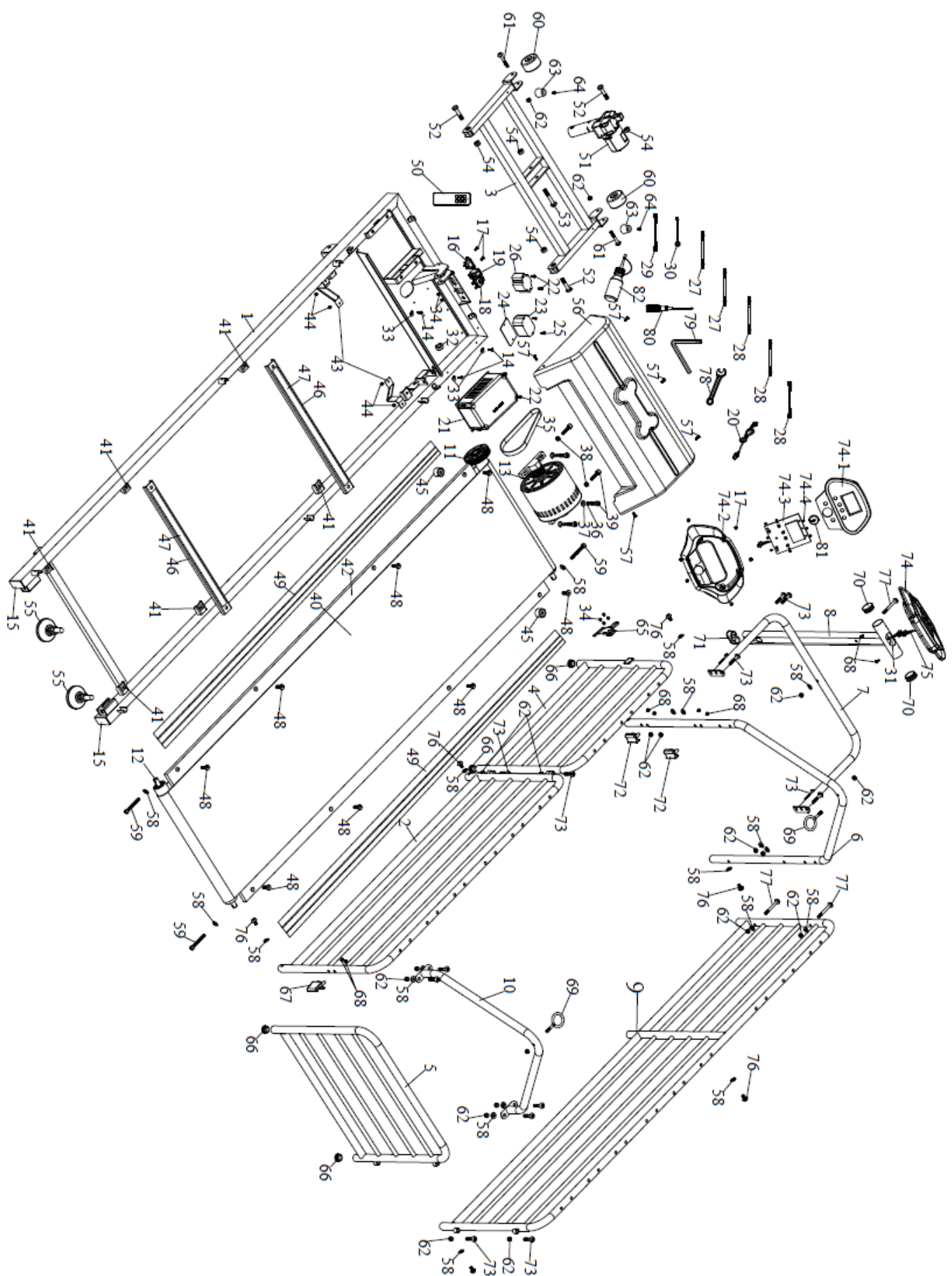

## PARTS LIST

No.	Description	Q'TY		No.	Description	Q'TY	
01	Main frame welding	1		44	Washer phillips self tapping	4	SH412
02	Right rails welding assembly	1	B00SGP01	45	Rubber cushion	2	PH83020
03	Incline welding assembly	1	C00SGP01	46	Reinforced bar for deck	2	NU550383
04	Front door welding assembly	1	D00ASGP01	47	EVA pad	2	PE305003
05	Rear door welding assembly	1	D00SGP01	48	Flat hex screw	8	SMM825 (M8*25)
06	Front hooker rack	1	E01SGP01	49	Footrail	2	PB168230
07	Front reinforced tube welding	1	F00SGP01	50	Remote Control	1	FY1254212
08	Console welding assembly	1	G00SGP01	51	Incline motor	1	FYSGP01
09	Left rails door	1	H00SGP01	52	Hex screw	3	SWM104526B
10	Fixing tube welding	1	J00SGP01	53	Hex screw	1	SWM106026B
11	Front roller	1	NQGSGP01	54	Nylock	4	SNM109TB
12	Rear roller	1	NHGSGP01	55	Foot rubber pad	2	
13	Motor	1	FMDWZ15HP	56	Motor cover	1	PMDSGP01
14	Washer phillips drilling screw	3	SH416Z	57	Truss phillips screw	5	SSM5105B
15	Square end cap	2	PP306015	58	Curved washer	20	SH81915B
16	Power cord socket	1	FDB-14-1F	59	Socket hex screw	3	SCM865B
17	Truss phillips self tapping	8	SS412	60	Transportation wheel	2	PY603585
18	Overload switch	1	FL2-10A	61	Truss hex screw	2	SSM85015B
19	I/O switch	1	FKCD4	62	Nylock	18	SNM8B
20	Power cord	1	FDP22100(1.0mm)	63	Rubber cushion	2	PH3026H
21	Inverter	1	FRM6T6S-SX66	64	Washer phillips drilling screw	2	SH425Z
22	Truss phillips screw	6	SSM515 (M5*15)	65	Buckle clip	1	NKSGP01
23	Filter	1	FHJ4-6A-T (020)	66	Round end cap	4	PY25415
24	Filter isolation plate	1	PL865612	67	Plastic latch (front)	1	PK502828
25	Plastic screw	2	SSJM412	68	Truss phillips self tapping screw	8	SS416 ( Φ4*16L
26	Choke	1	FHJ4830-06-001(170mm)	69	Front Rack hooker	2	SW8746M8
27	Single cable	2	FD16100R(16AWGX100)	70	Flat round end cap	2	PPY3815
28	Single cable	3	FD16100B(16AWGX100)	71	Flat oval end cap	1	PPT255015
29	Single cable	1	FD16250R	72	Plastic latch	2	PK502651
30	Ground wire	1	FJD20150(20AWGX150)	73	Truss hex screw	10	SSM84020B
31	Control cable-lower	1		74	Computer assembly	1	
32	Ferrite core	1	FC311913	74-1	Computer upper cover	1	PDSGP01-S
33	Retaining ring	3	PY64mm (Φ5)	74-2	Inner computer cover	1	PDSGP01-L
34	Truss phillips & internal	6	SSM58Z	74-3	Upper control board+Control	1	
35	Drive belt	1		74-4	Round phillips self tapping	8	SS236 (Φ2.3*6L )
36	Spring washer	4	ST815 (Φ8X1.5T)	75	Control cable-upper	1	FKS1504PIN
37	Washer	4	SP81815 (Φ8.5*φ18*1.5t)	76	Truss hex screw	6	SSM815B
38	Nut	2	NHM8A	77	Truss hex screw	3	SSM86515B
39	Socket hex steel screw	6	SCM835 (M8*35mm)	78	Wrench tool	1	SL13KB
40	Running belt	1	PP460365016	79	Hex Wrench	1	SZM6
41	EVA pad	6	PE30303	80	Screwdriver	1	SSZLSD
42	Running board	1	PP167055015	81	Safety key	1	FNSGP01
43	Belt blocking sheet	2	NZ1155425	82	Silicon oil	1	PZ30ML